

# VUE À PLAT DES ÉLÉMENTS POUR LA RÉALISATION DES MEUBLES POUR UN LAND ROVER DEFENDER 110

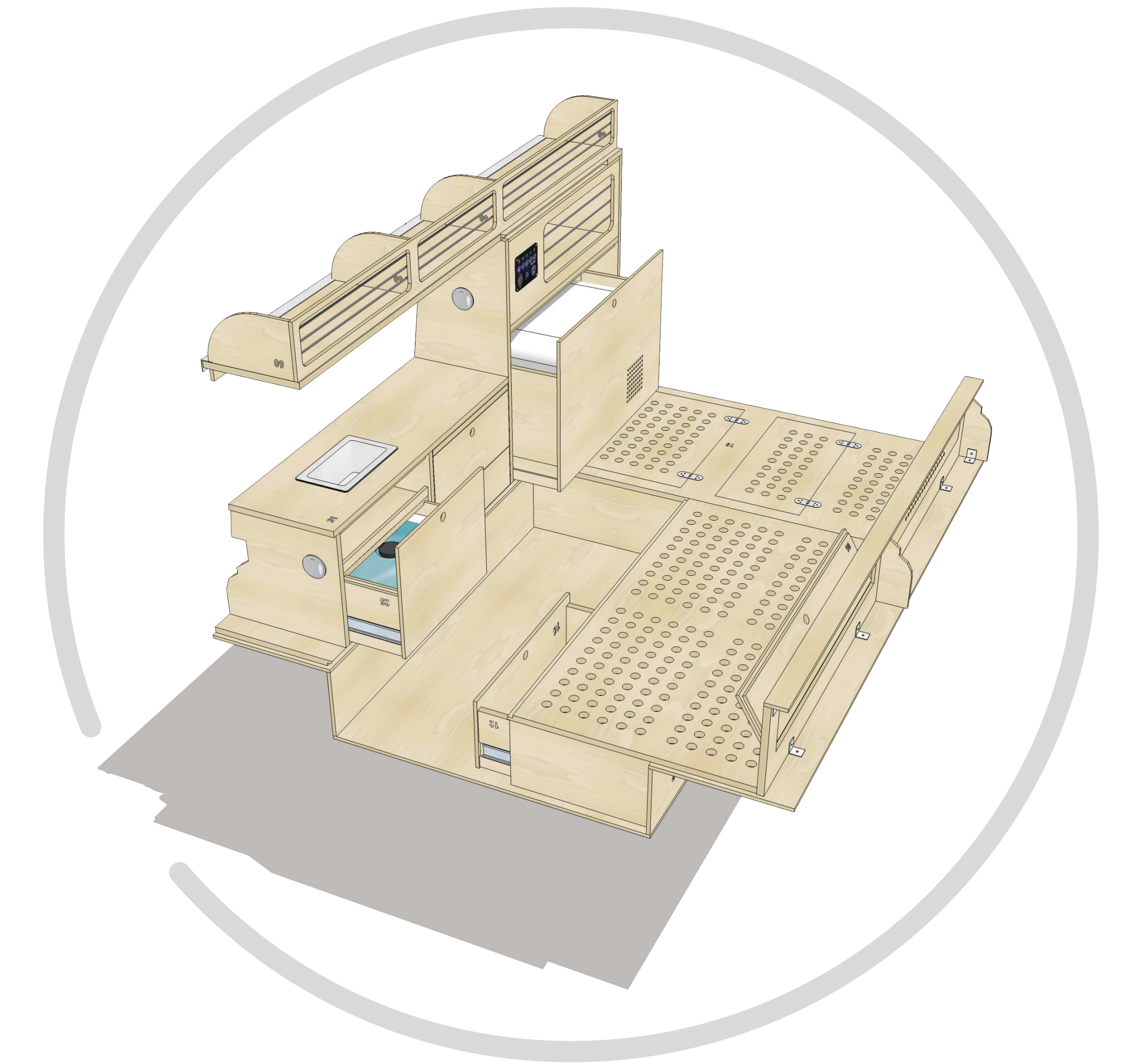
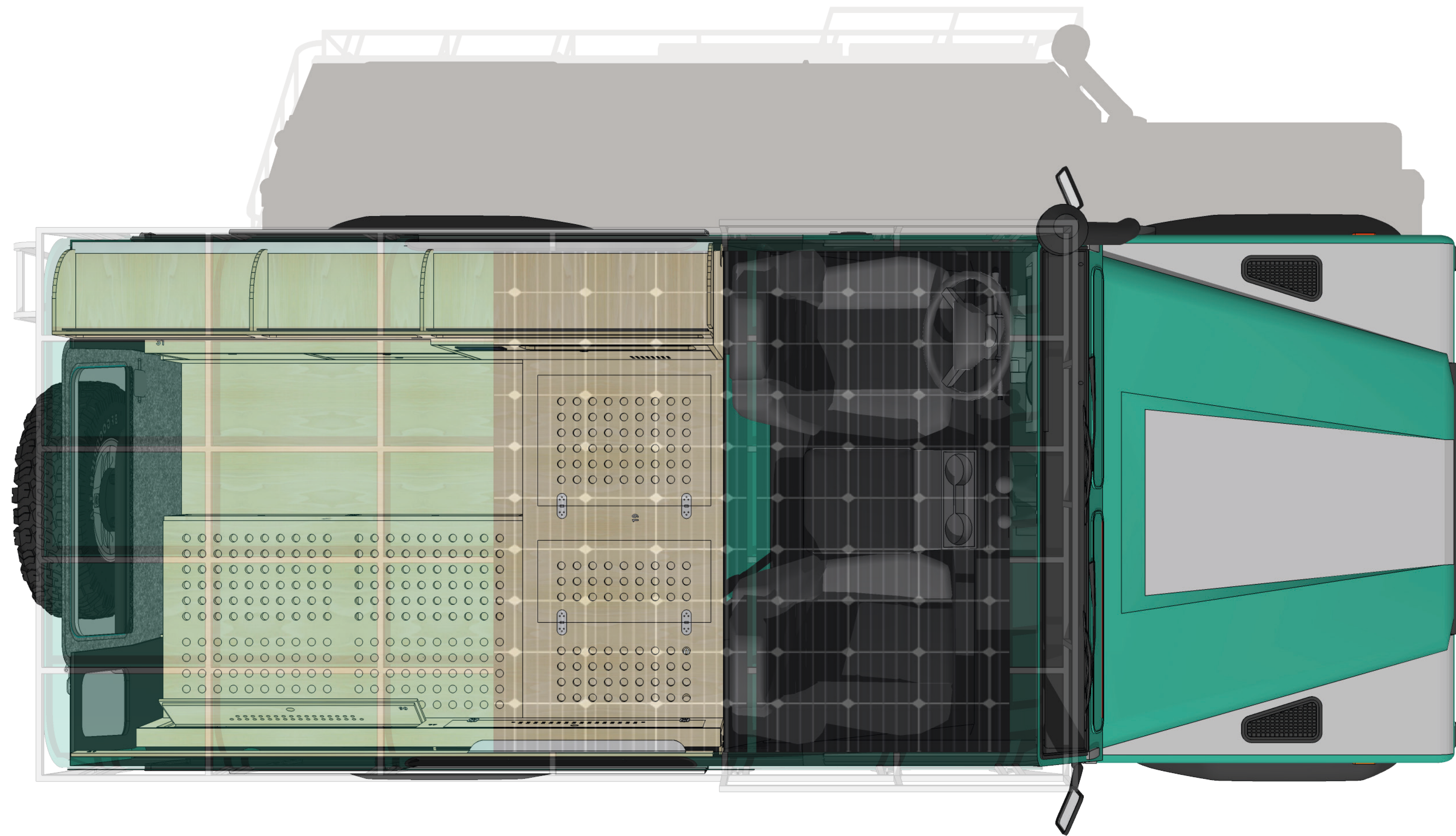

**READY-FOR-ADVENTURE.COM**

T-SHIRTS HOMMES ET FEMMES D'INSPIRATION LAND ROVER DEFENDER & SERIES

**ATTENTION :** Selon l'épaisseur de l'isolant que vous avez choisie, il faudra ajuster les tailles des éléments des meubles.

**PLAN 3D**

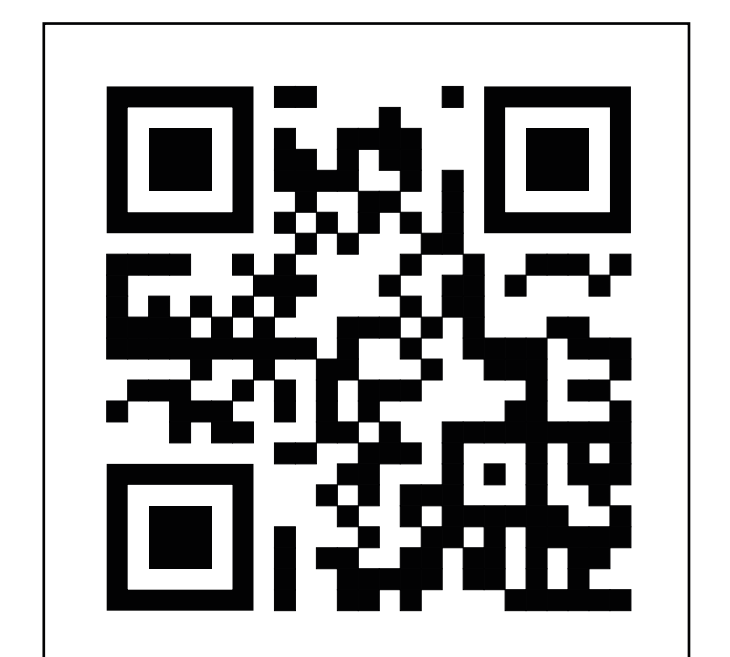

FLASHER POUR RETOURNER LES PLANS 3D SKETCHUP

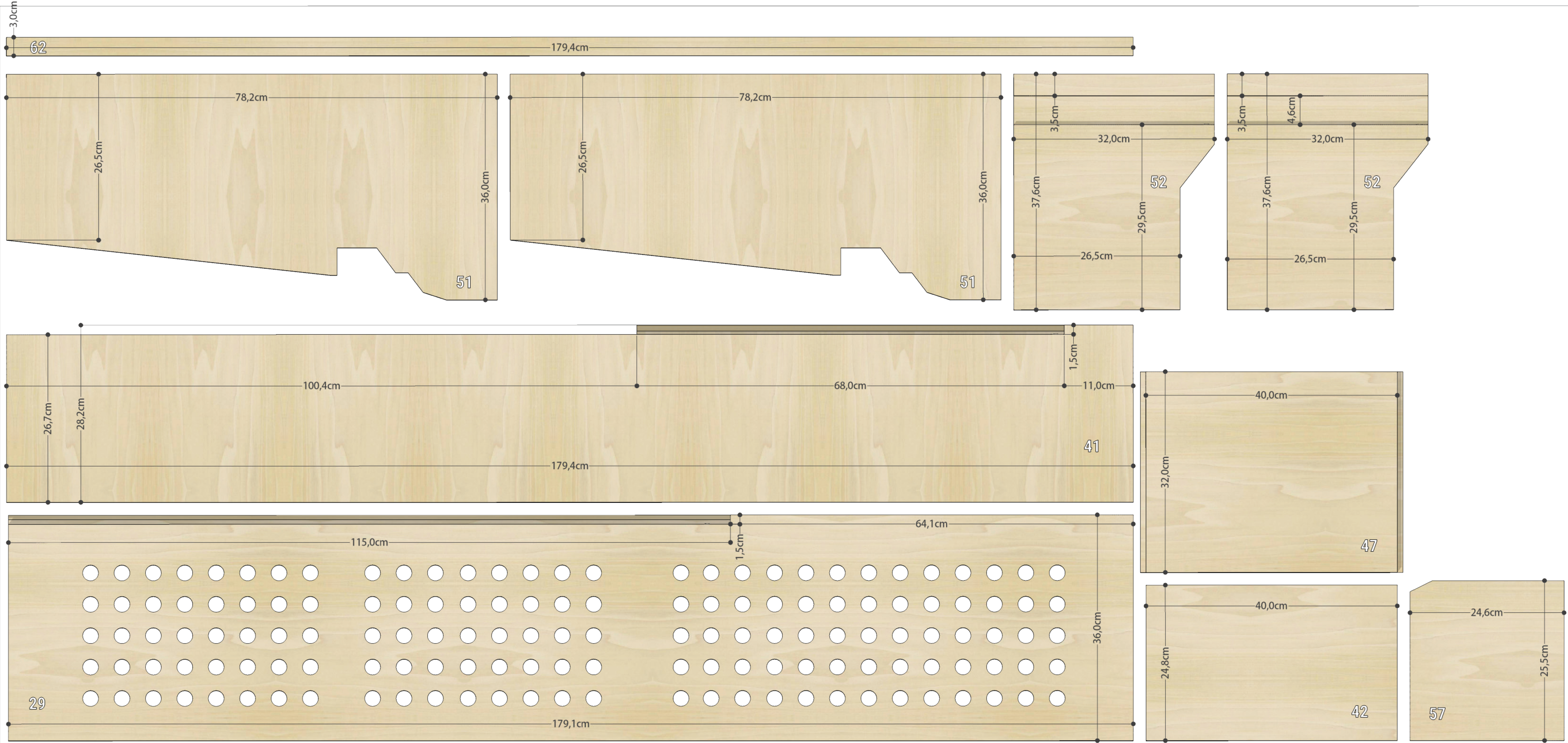

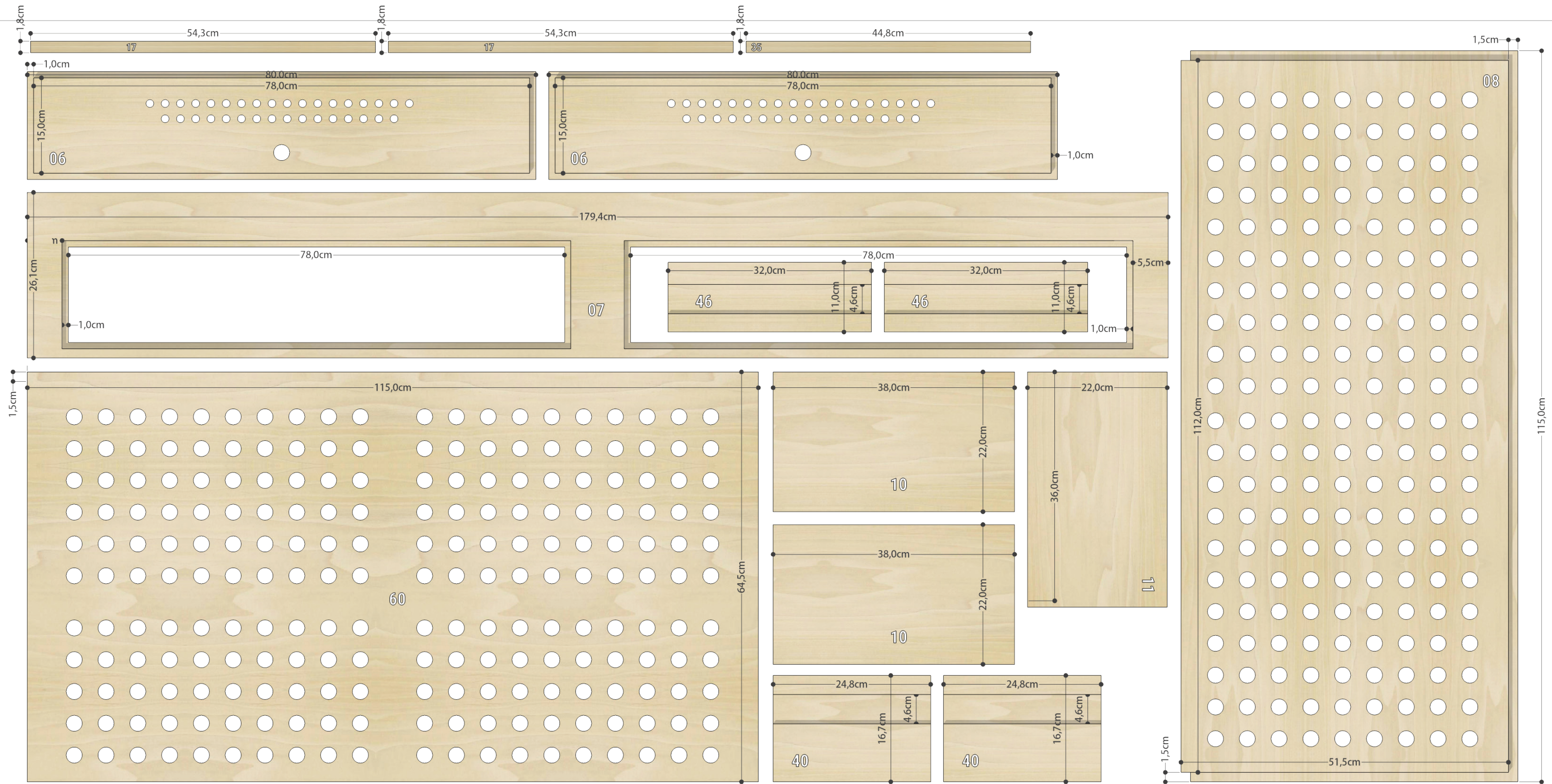

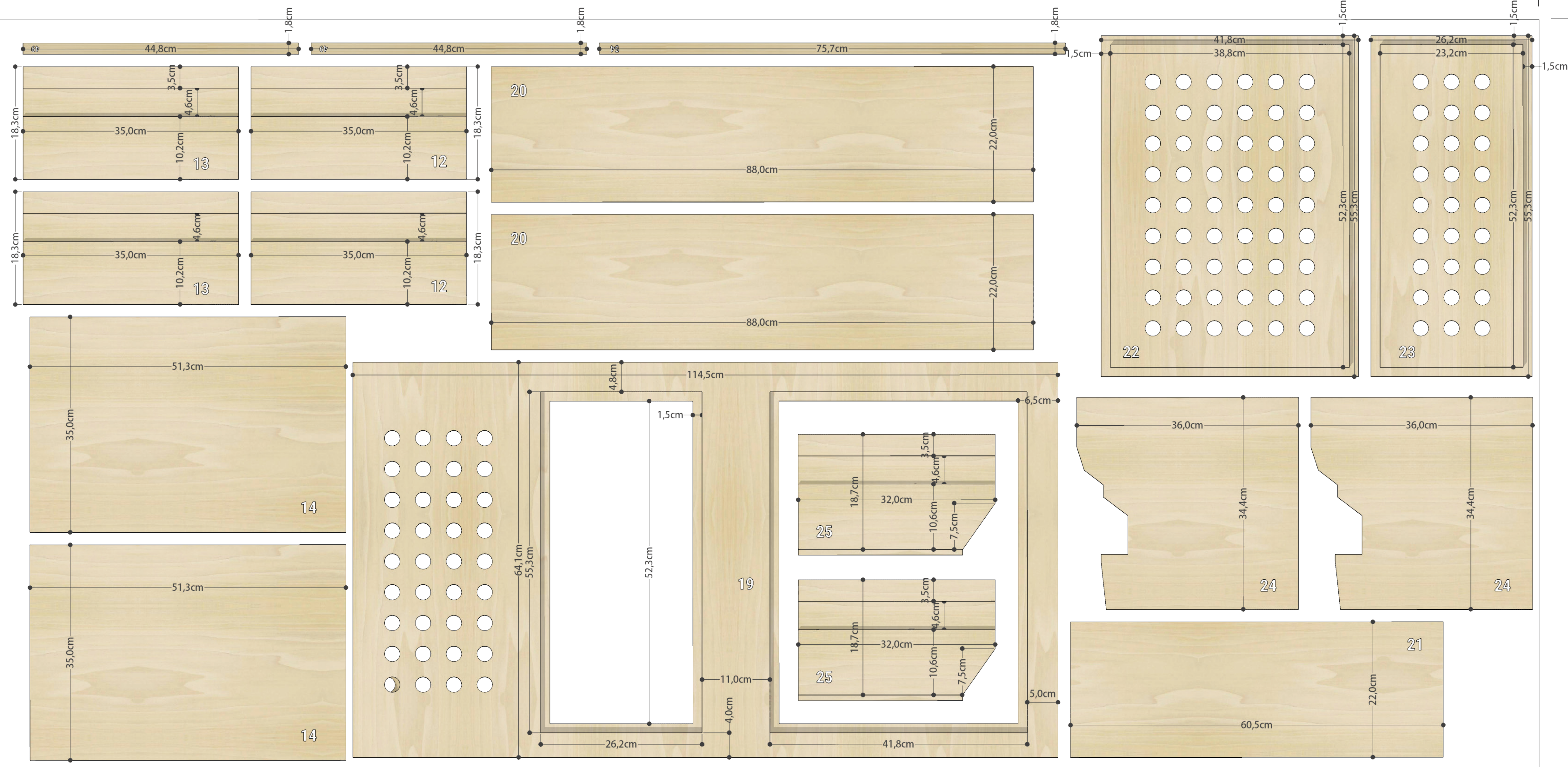



## PLAN 3D

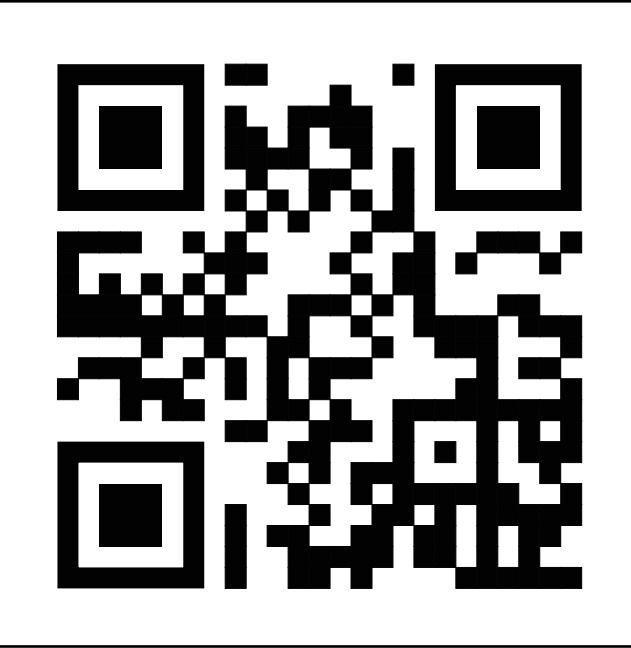

FLASHER POUR RETOURNER  
LES PLANS 3D SKETCHUP

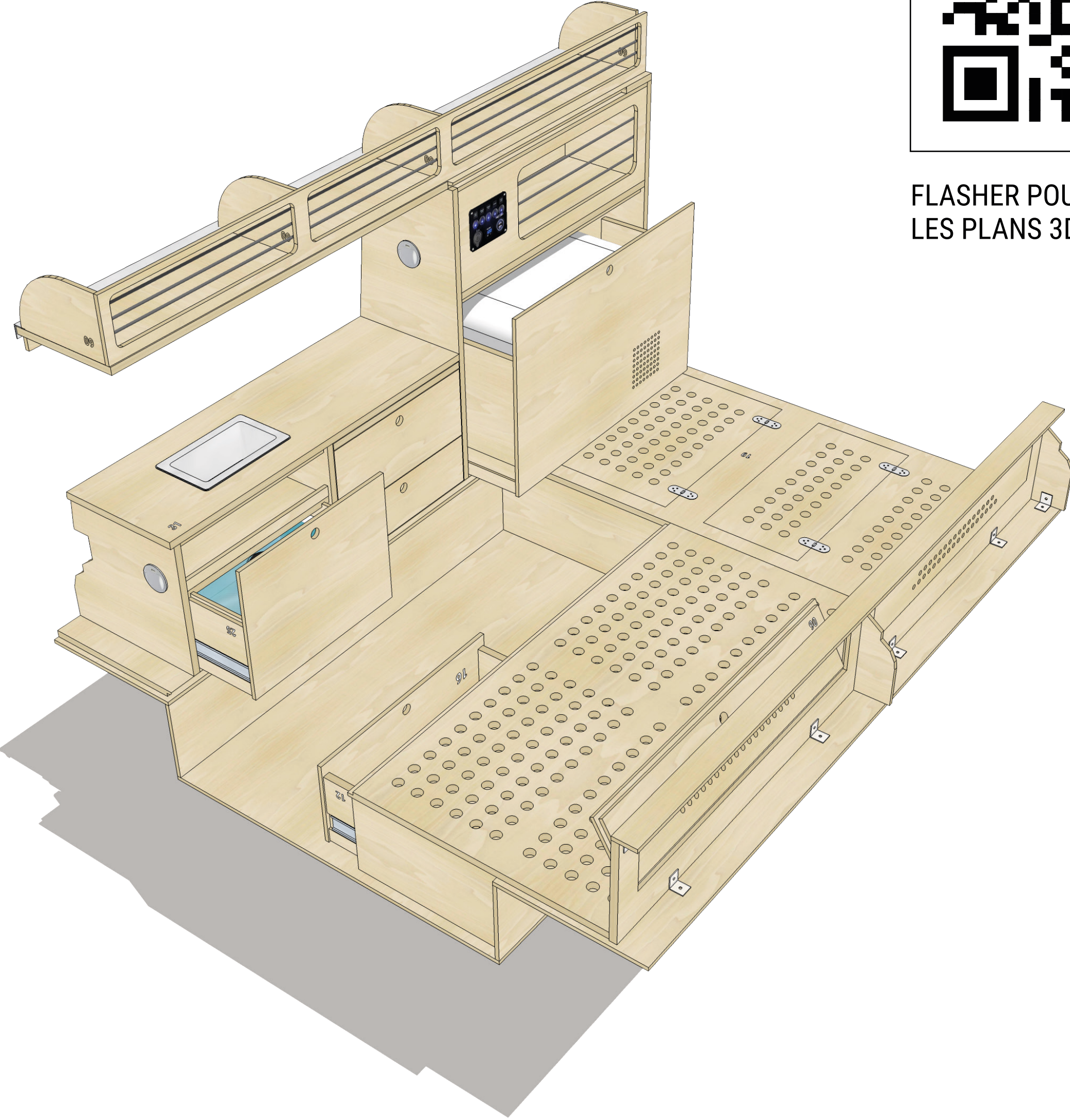

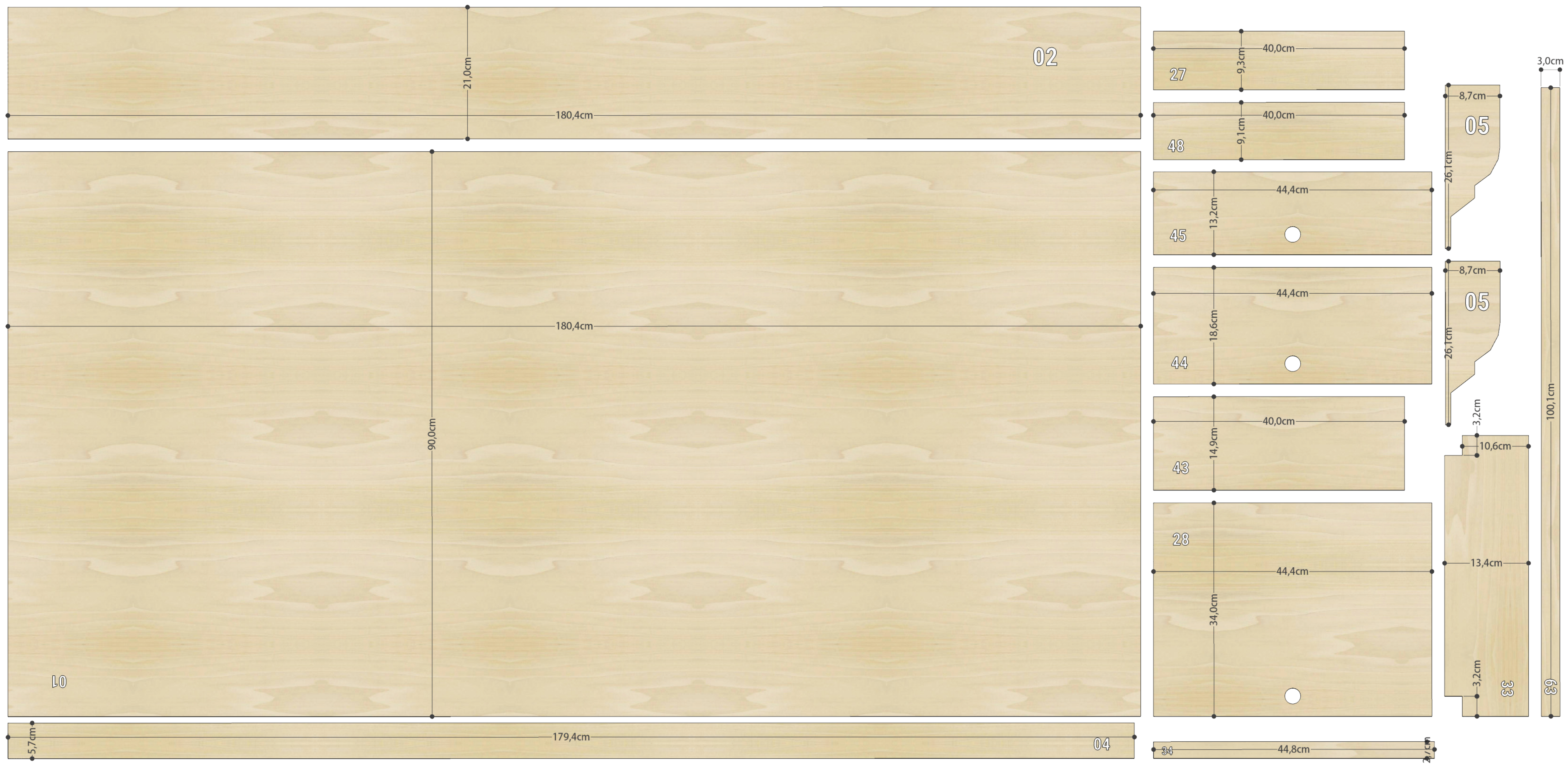

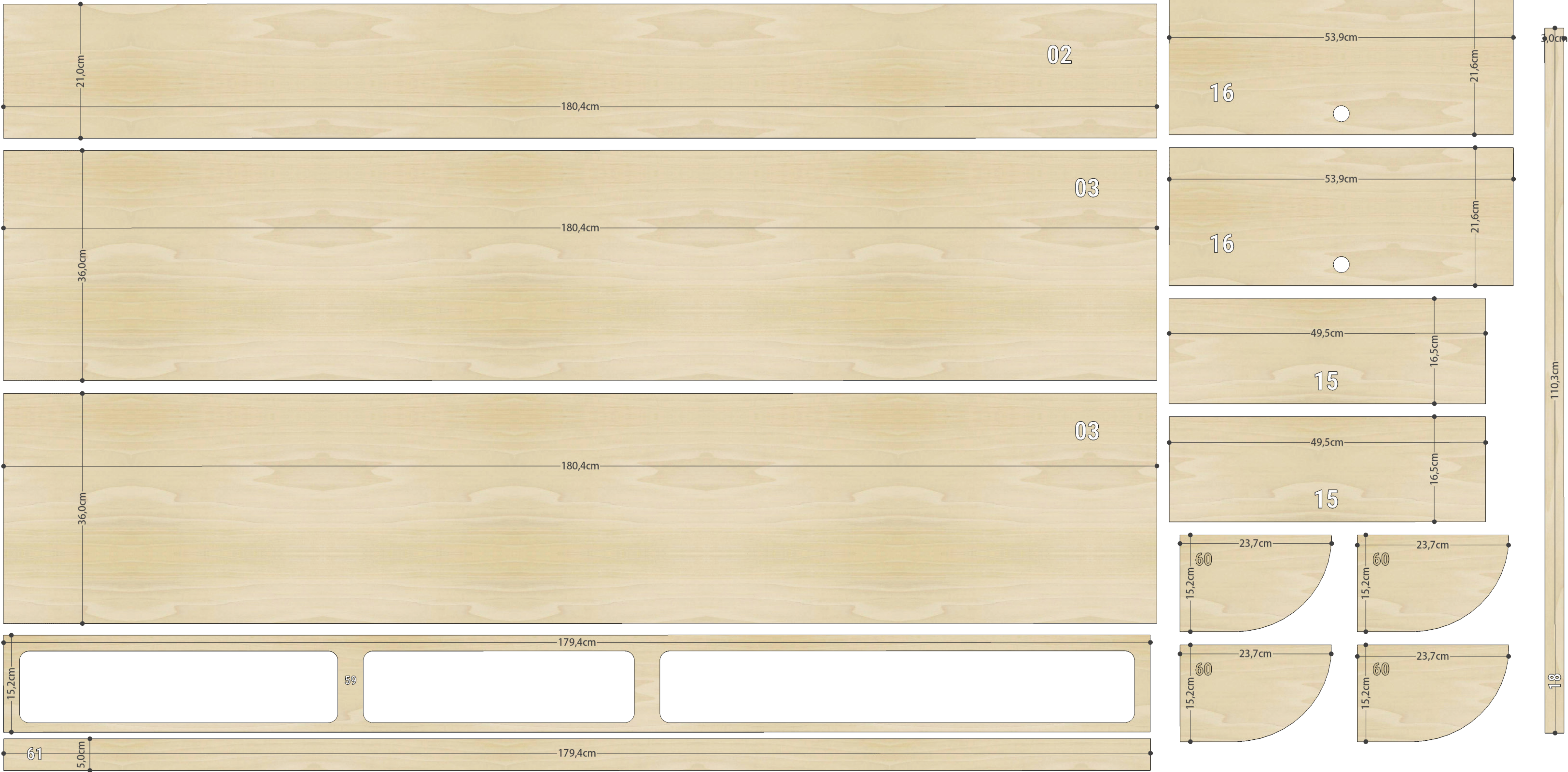

## PLAN 3D

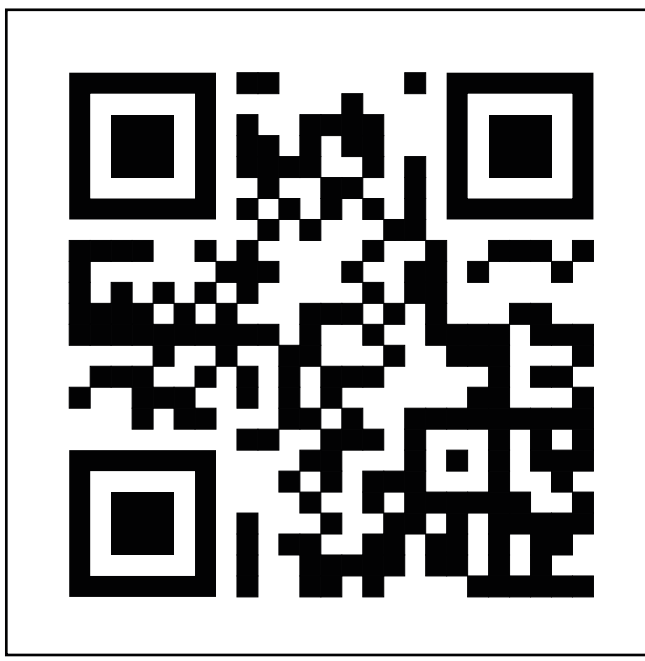

FLASHER POUR RETOURNER  
LES PLANS 3D SKETCHUP

